

尺寸/Dimensions 单位/Unit=mm

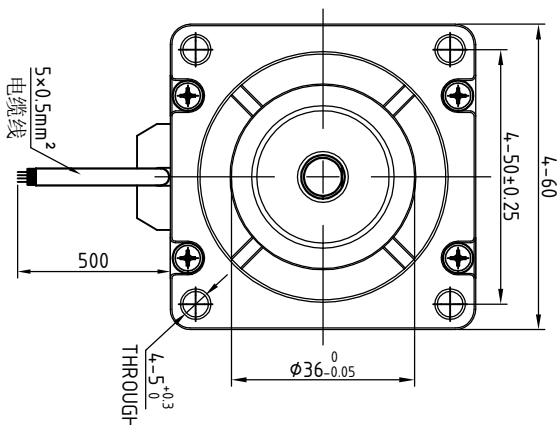

60CM21-D2 V2.0

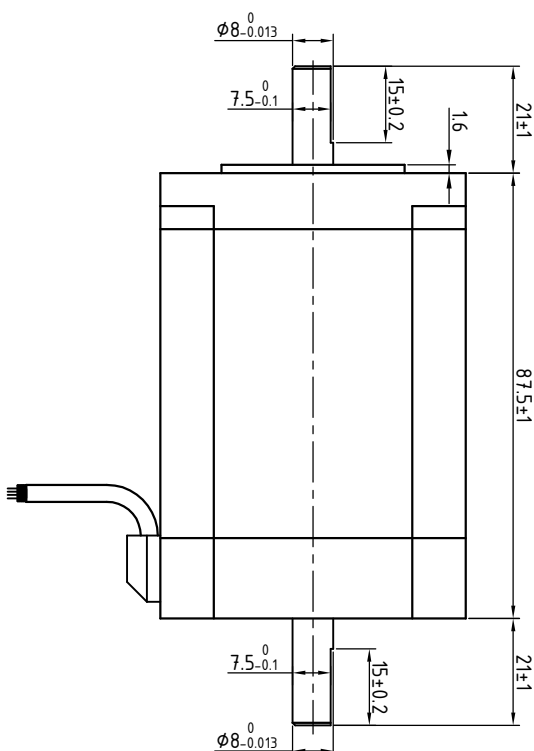
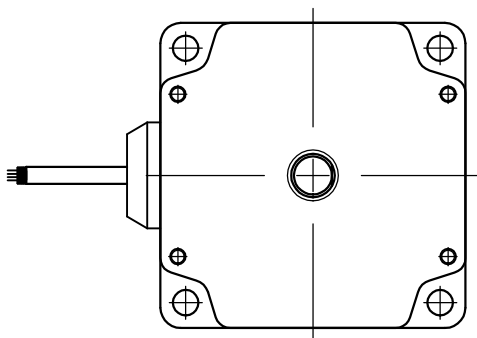

电动机规格书/Motor Specification

相数/Number Of Phase	5
基本步距角/Basic Step Angle	0.72°
基本步距角误差(空载)/Positional Accuracy(no-load)	±5%以下/Max
额定电压(相)/Rated Voltage(Phase)	V(DC)
额定电流(相)/Rated Current(Phase)	2.4A
电阻(相)/Resistance(Phase)@20°C	0.69Ω±5%
电感(相)/Inductance(Phase)@1kHz	3.0mH±20%
保持力矩/Holding Torque	2 N·m
转子惯量/Rotor Inertia	≤g·cm ²
质量/Mass	Kg
径向跳动(最大)/Radial Play(Max)	0.025mm(lead/负载 450g)
轴向跳动(最大)/Axial Play(Max)	0.075mm(lead/负载 920g)
额定工作状态/Duty	连续/Continuous
绝缘耐压/Dielectric Strength	500V A.C
绝缘电阻/Insulation Resistance	100MΩ Min/500VDC
温升/Temperature Rise	B
使用温度范围/Operation Ambient Temperature	0°C~+50°C
使用湿度范围/Operation Ambient Humidity	20%RH~90%RH
保存温度范围/Storage Ambient Temperature	-20°C~+70°C
保存湿度范围/Storage Ambient Humidity	15%RH~95%RH

接线图/Wiring Diagram

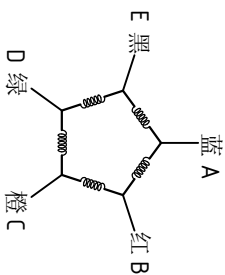

励磁顺序 (5相励磁)
Phase Sequence(5 Phase Exciting)

铭牌内容/Label Description

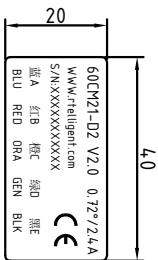

第一角画法
First Angle View



05		批准 Approved							
04		审核 Checked							
03		设计 Designed							
02		设计 Designed							
01	型号更改 Type Change	设计 Designed							
00	初版/First Edition	设计 Designed							
版本 Edition	变更内容 Revisions	设计 Designed	日期 Date	制图 Drawn					
3									
2									
1									

材料
Material



表面处理
Finish



公差
Tolerance



比例
Scale



页
Sheet

